

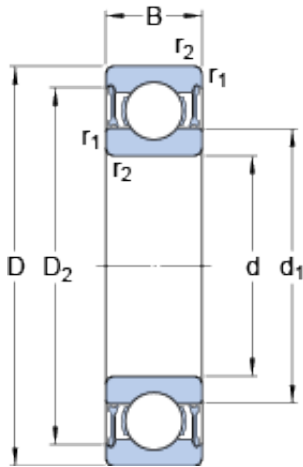

## NTN-SNR BEARING RULMENTI S.R.L.



40 mm x 62 mm x 12 mm skf 61908-2RZ Deep groove ball bearings

Bearing No. 61908-2RZ

61908-2RZ Bearing 2D drawings and 3D CAD models

Size	62x40x12 mm
Bore Diameter	62 mm
Outer Diameter	40 mm
Width	12 mm
d	40 mm
D	62 mm
B	12 mm
d <sub>1</sub>	46.9 mm
D <sub>2</sub>	57.3 mm
r <sub>1,2</sub> - min.	0.6 mm
d <sub>a</sub> - min.	43.2 mm
d <sub>a</sub> - max.	46.8 mm
D <sub>a</sub> - max.	58.8 mm
r <sub>a</sub> - max.	0.6 mm
Basic dynamic load rating - C	13.8 kN
Basic static load rating - C <sub>0</sub>	10 kN
Fatigue load limit - P <sub>u</sub>	0.425 kN
Reference speed	24000 r/min
Limiting speed	12000 r/min
Calculation factor - k <sub>r</sub>	0.02
Calculation factor - f <sub>0</sub>	15.6
Category	Single Row Ball Bearings
Inventory	0.0
Manufacturer Name	SKF



## NTN-SNR BEARING RULMENTI S.R.L.

Minimum Buy Quantity	N/A
Weight / Kilogram	0.124
Product Group	B00308
Enclosure	2 Seals
Precision Class	ABEC 1   ISO P0
Maximum Capacity / Filling Slot	No
Rolling Element	Ball Bearing
Snap Ring	No
Internal Special Features	No
Cage Material	Steel
Enclosure Type	Non-Contact Seal
Internal Clearance	C0-Medium
Inch - Metric	Metric
Long Description	40MM Bore; 62MM Outside Diameter; 12MM Outer Race Diameter; 2 Seals; Ball Bearing; ABEC 1   ISO P0; No Filling Slot; No Snap Ring; No Internal Special Features
Category	Single Row Ball Bearing
UNSPSC	31171504
Harmonized Tariff Code	8482.10.50.68
Noun	Bearing
Keyword String	Ball
Manufacturer URL	<a href="http://www.skf.com">http://www.skf.com</a>
Manufacturer Item Number	61908-2RZ
Weight / LBS	0.273
Outer Race Width	0.472 Inch   12 Millimeter
Outside Diameter	2.441 Inch   62 Millimeter
Bore	1.575 Inch   40 Millimeter
bore diameter:	40 mm
static load capacity:	10 kN



## NTN-SNR BEARING RULMENTI S.R.L.

outside diameter:	62 mm
precision rating:	Not Rated
overall width:	12 mm
finish/coating:	Uncoated
bore type:	Round
cage material:	Steel
closure type:	Double Sealed
outer ring width:	12 mm
row type & fill slot:	Single Row Non-Fill Slot
fillet radius:	0.6 mm
internal clearance:	C0
maximum rpm:	12000 RPM
operating temperature range:	-40 to +210 ° F
series:	61
dynamic load capacity:	13.8 kN
$d_1$	46.9 mm
$D_2$	57.55 mm
$r_{1,2}$ min.	0.6 mm
$d_a$ min.	43.2 mm
$d_a$ max.	46.8 mm
$D_a$ max.	58.8 mm
$r_a$ max.	0.6 mm
Basic dynamic load rating C	13.8 kN
Basic static load rating $C_0$	10 kN
Fatigue load limit $P_u$	0.425 kN
Calculation factor $k_r$	0.02
Calculation factor $f_0$	15.6
Mass bearing	0.12 kg