

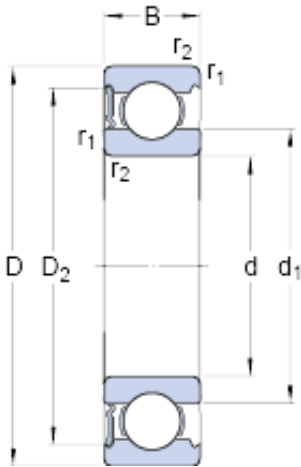

## NTN-SNR BEARING RULMENTI S.R.L.



6206-RS1 Bearing 2D drawings and 3D CAD models

30 mm x 62 mm x 16 mm skf 6206-RS1 Deep groove ball bearings

Bearing No. 6206-RS1

Size	62x30x16 mm
Bore Diameter	62 mm
Outer Diameter	30 mm
Width	16 mm
d	30 mm
D	62 mm
B	16 mm
d <sub>1</sub>	40.36 mm
D <sub>2</sub>	54.06 mm
r <sub>1,2</sub> - min.	1 mm
d <sub>a</sub> - min.	35.6 mm
d <sub>a</sub> - max.	40.3 mm
D <sub>a</sub> - max.	56.4 mm
r <sub>a</sub> - max.	1 mm
Basic dynamic load rating - C	20.3 kN
Basic static load rating - C <sub>0</sub>	11.2 kN
Fatigue load limit - P <sub>u</sub>	0.475 kN
Limiting speed	7500 r/min
Calculation factor - k <sub>r</sub>	0.025
Calculation factor - f <sub>0</sub>	14
Category	Single Row Ball Bearings
Inventory	0.0
Manufacturer Name	SKF
Minimum Buy Quantity	N/A



## NTN-SNR BEARING RULMENTI S.R.L.

Weight / Kilogram	0.203
EAN	7316577740984
Product Group	B00308
Enclosure	1 Seal
Precision Class	ABEC 1   ISO P0
Maximum Capacity / Filling Slot	No
Rolling Element	Ball Bearing
Snap Ring	No
Internal Special Features	No
Cage Material	Steel
Enclosure Type	Contact Seal
Internal Clearance	C0-Medium
Inch - Metric	Metric
Long Description	30MM Bore; 62MM Outside Diameter; 16MM Outer Race Diameter; 1 Seal; Ball Bearing; ABEC 1   ISO P0; No Filling Slot; No Snap Ring; No Internal Special Features
Category	Single Row Ball Bearing
UNSPSC	31171504
Harmonized Tariff Code	8482.10.50.68
Noun	Bearing
Keyword String	Ball
Manufacturer URL	<a href="http://www.skf.com">http://www.skf.com</a>
Manufacturer Item Number	6206-RS1
Weight / LBS	0.448
Outer Race Width	0.63 Inch   16 Millimeter
Outside Diameter	2.441 Inch   62 Millimeter
Bore	1.181 Inch   30 Millimeter
bore diameter:	30 mm
static load capacity:	11.2 kN



## NTN-SNR BEARING RULMENTI S.R.L.

outside diameter:	62 mm
precision rating:	Not Rated
overall width:	16 mm
finish/coating:	Uncoated
bore type:	Round
cage material:	Steel
closure type:	Single Seal
outer ring width:	16 mm
row type & fill slot:	Single Row Non-Fill Slot
fillet radius:	1 mm
internal clearance:	C0
maximum rpm:	7500 RPM
operating temperature range:	-40 to +210 ° F
series:	62
dynamic load capacity:	20.3 kN
$d_1$	40.36 mm
$D_2$	54.06 mm
$d_a$ min.	35.6 mm
$d_a$ max.	40.3 mm
$D_a$ max.	56.4 mm
$r_a$ max.	1 mm
Basic dynamic load rating C	20.3 kN
Basic static load rating $C_0$	11.2 kN
Fatigue load limit $P_u$	0.475 kN
Calculation factor $k_r$	0.025
Calculation factor $f_0$	14
Mass bearing	0.2 kg