

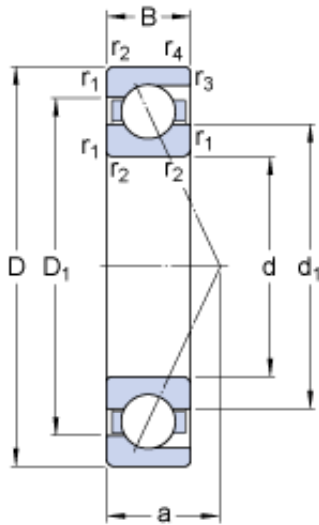

NTN-SNR BEARING RULMENTI S.R.L.



1000 mm x 1220 mm x 100 mm skf 718/1000
AMB Single row angular contact ball bearings

Bearing No. 718/1000 AMB

718/1000 AMB Bearing 2D drawings and 3D CAD models

Size	1220x1000x100 mm
Bore Diameter	1220 mm
Outer Diameter	1000 mm
Width	100 mm
d	1000 mm
D	1220 mm
B	100 mm
d ₁	1073.3 mm
D ₁	1150.8 mm
a	370 mm
r _{1,2} - min.	6 mm
r _{3,4} - min.	3 mm
d _a - min.	1023 mm
D _a - max.	1197 mm
D _b - max.	1207 mm
r _a - max.	5 mm
r _b - max.	2.5 mm
Basic dynamic load rating - C	923 kN
Basic static load rating - C ₀	2750 kN
Fatigue load limit - P _u	39 kN
Reference speed	400 r/min
Limiting speed	430 r/min
Calculation factor - k _r	0.08
Calculation factor - k _a	0.3



NTN-SNR BEARING RULMENTI S.R.L.

Calculation factor - e	0.8
Calculation factor - X	0.63
Calculation factor - Y_0	0.66
Calculation factor - Y_1	0.78
Calculation factor - Y_2	1.24
Calculation factor - X	0.39
Calculation factor - Y_0	0.33
Calculation factor - Y_1	
Calculation factor - Y_2	0.76
d_1	1073.3 mm
D_1	1150.8 mm
$r_{1,2}$ min.	6 mm
$r_{3,4}$ min.	3 mm
d_a min.	1023 mm
D_a max.	1197 mm
D_b max.	1207 mm
r_a max.	5 mm
r_b max.	2.5 mm
Basic dynamic load rating C	923 kN
Basic static load rating C_0	2750 kN
Fatigue load limit P_u	39 kN
Calculation factor A	65.4
Calculation factor k_r	0.08
Calculation factor e	0.8
Calculation factor X	0.39
Calculation factor Y_0	0.33
Calculation factor Y_2	0.76
Calculation factor X	0.63
Calculation factor Y_0	0.66
Calculation factor Y_1	0.78
Calculation factor Y_2	1.24



NTN-SNR BEARING RULMENTI S.R.L.

Mass bearing	
--------------	--

	243 kg
--	--------